

Humidifan

Bathroom (and toilet) Fan HF100 240V



The Humidifan series of automatic extract fans are designed for the specifier and contract user and, though competitively priced, offer many features only available on more expensive extract fans.

Three notable features are: ball bearing motor, auto reset thermal cut out and a lifetime guarantee on the sensor head. This model can be upgraded to an advanced Real Time data logging Datamatic fan system.

Special Features

- Lifetime guarantee on the humidity sensor head
- Three year guarantee
- Ball bearing fan motor
- Integral or remote humidity sensor
- Auto reset thermal cut out fuse on fan motor
- Night time set back to inhibit fan running in the silent hours
- Silent integral mechanical back-draught shutters
- Manual over-ride on switch
- Wall, window or ceiling fit
- Anticipatory response humidity sensor
- Can be upgraded to Datamatic 100 Real Time data logging fan with remote humidity sensor
- Complies with Building Regulations
- Quiet running
- Range of accessories
- Full technical back up

Operation

Under the control of a microprocessor, the sensor monitors continuously the Relative Humidity (RH) in the room. If there is a sudden rise in the RH, the sensor anticipates hitting the set point and activates the fan before it is reached. After the fan has reduced the RH to about 5% below the preset set point, the fan switches off. When the fan is running under sensor and microprocessor control the L.E.D. flashes.

The user can override the automatic monitoring by pulling the cord. In this override on mode, the red L.E.D. lights continuously. This shows the user that the fan is under manual operation. When the cord is pulled again, the sensor and microprocessor take back control of the fan.



Humidifan

Bathroom (and toilet) Fan HF100 240V

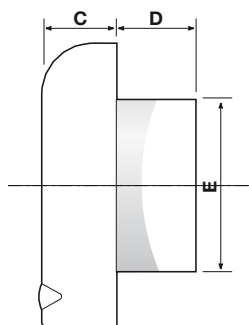
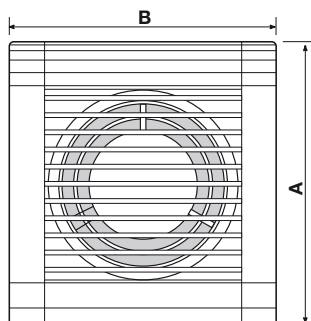

SPECIFICATION KEY FACTS

- Silent integral mechanical back-draught shutter
- Anticipatory control
- Contamination proof sensor head with lifetime guarantee
- 2 year guarantee as standard
- Ball bearing motor
- Auto reset thermal cut out

ORDER CODES

HF100	Fan with integral humidity sensor
HF100/REM	Kit comprising fan and separate humidity sensor
HF100T/REM	Kit comprising fan and separate humidity sensor/timer
HF100T	With timed over-run for integral bathrooms and toilets (no humidity sensor)
W100	Wall fixing kit
G100	Window fixing kit
C100	Ceiling fixing kit
HF4	100mm fan only
HF4 PC	100mm fan with pull cord
HF4T	100mm fan with timer

Construction

The Humidifan combines stylish attractive case design with advanced electronic automatic controls. The motor is double insulated and is of the shaded pole type mounted on self-lubricating ball-bearings. The motor incorporates an overload protection device and conforms to EEC Directive 78-889 for radio interference. It will operate in ambient temperatures of up to 40°C. The fan complies to BS3456, BS800 and BS5490. The unit incorporates an electronic humidity sensor.

Installation

The modular concept of the fan makes it easy to install in a WALL, CEILING or WINDOW.

WALL: easily installed with a wall venting kit comprising a wall sleeve and outside wall grille.

CEILING: time saving, optional ceiling ring available for fitting into plasterboard. 100mm flexible ducting.

WINDOW: single pane or sealed unit easily installed with window kit.

In many instances, a passive air vent, or an air brick, may need to be fitted to other cooler rooms within the property, in order to promote a good airflow throughout the dwelling.

Fitting Kits available:

WALL: Comprises wall sleeve and external grille (available in brown, terracotta, buff or white)

WINDOW: Mounting unit suitable for S/G or D/G windows.

For greater efficiency we would recommend that a fan and remote sensor configuration of this model be used for this application, order code HF100/REM/G100.

CEILING: Ceiling ring available for fitting into plasterboard. 100mm dia. ducting will be required. We only recommend that this axial fan be ducted a maximum 1.5 metres. For greater distances, a centrifugal or mixed flow type unit would be more appropriate. (see Centramatic and remote sensors data sheet)

FAN DIMENSIONS

Dimensions	A 164mm	B 154mm	C 42mm	D 46mm	E 98mm
Hole dimensions	Walls	107mm dia.			
	Windows	130mm dia.			
	Ceilings	107mm dia.			
Insulation	Double insulated				
Voltage	240				
Power	15 watts				
Extract capacity	85 Cubic m/hr, 23 litres/sec				
Pressure mm H ₂ O	3.4				
dB(A)	38				

HUMIDITY SENSOR

Set at manufacture to activate the fan approaching 67% RH at 20°C

Night time set back 1% increase in set point for every 1°C below 20°C.

TIMER RANGE

Timer range 1 to 30 minutes*

*At manufacture, the timer is set for a 15 minute overrun period. At installation, or subsequently, the scaled adjustment dial permits the timed period to be changed in the range 1 to 30 minutes.



HEAD OFFICE

Stathe Road
Burrowbridge
Somerset, TA7 0RY
Tel: 01823 690292 Fax: 01823 690291
Email: info@airtechaunton.co.uk
www.airtechenvironmental.co.uk

LONDON & SOUTH EAST REGION

Suite 2, First Floor, Cadogan House,
36 Central Avenue, West Molesey,
Surrey, KT8 2QZ
Tel: 020 8941 8722 Fax: 020 8941 9623
Email: info@airtechlondon.co.uk
www.airtechenvironmental.co.uk

SOUTH WEST REGION

Unit 2 Halwin Industrial Estate
Porkellis, Helston
Cornwall, TR13 0LA
Tel: 01326 341 423 Fax: 01326 341 467
Email: info@airtechaunton.co.uk
www.airtechenvironmental.co.uk